



Harvest Station Commercial Rezoning and Site Plan P20-0058 & P20-0059

Council Briefing





Aerial Photo

- 12.33 acres

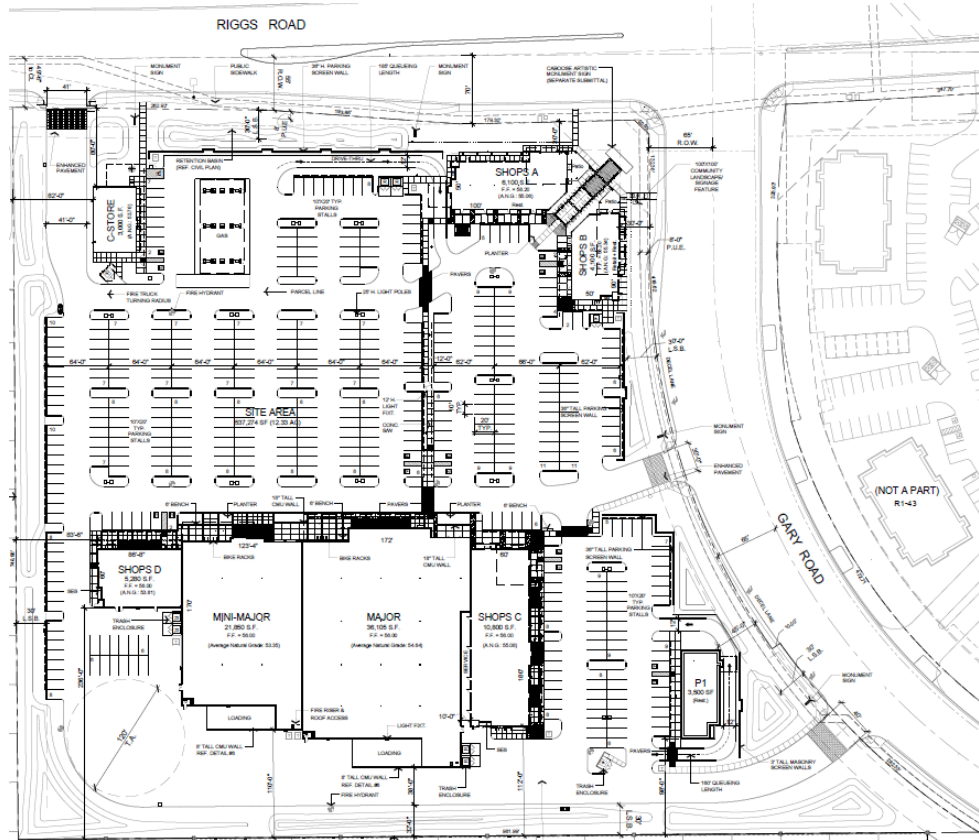

Site Plan

- 87,235 sq. ft. total
- Shops A = 6,100 sq. ft.
- Shops B = 1,748 sq. ft.
- Major = 36,105 sq. ft.
- No known users

Project Details

- Rezone from R1-5/PAD to C-2
- No proposed deviations from C-2 standards
- CUP req'd. for fuel station
- 2 neighborhood meetings – NO correspondence received
- PZ 7-0 recommendation for approval

